

Circuit diagram
Normal: 1-2 on 4-5
press: 2-3 on 5-6 on

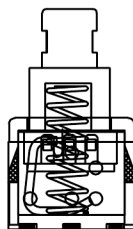
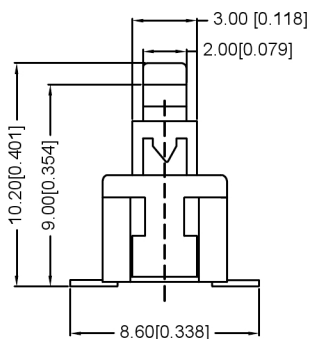

特性:

NOTES:

1. 额定电流: 100mA 30V DC
1. Rated current: 100mA 30V DC
2. 接触电阻: ≤ 200Ω
2. Contact resistance: ≤ 200m Ω
3. 压力: 250 ± 50GF
3. Press: 250 ± 50gf
4. 最大行程: 2.0 + 0.2mm
4. Maximum travel: 2.0 + 0.2mm
5. 绝缘电阻: 100mΩ
5. Insulation resistance: 100mΩ
6. 寿命: 10000
6. Life: 10000

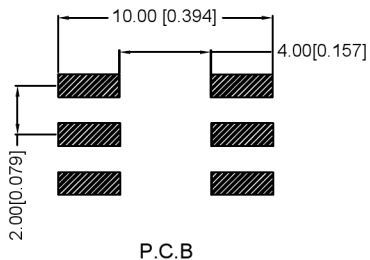
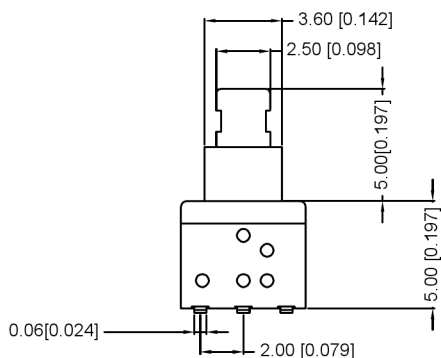

NO	PAPT NAME	MATERIAL	PLATINGS COLOP
1	HOUSING	PPA	GRAY
2	BUTTON	H62	Ag-Plated
3	HANDLE	PA6T	WHITE
4	COVER	PPA	BLACK
5	CONTACT SPRING	Compound silver	—————
6	SPRING	Stainless steel wire	—————
7	HANGER	Stainless steel wire	—————

广东星坤科技股份有限公司

日期

文件工程章

REVISIONS	DATE	REVISED	APPROVED	UNSPECIFIED TOLERANCES
ΔX				ANGULAR ±5°
ΔX				L ≤ 4 ±0.2
ΔX				4 < L ≤ 16 ±0.3
MARK				16 < L ≤ 63 ±0.4
				L > 63 ±0.5



DSND		SCALE: N/A	MODEL TYPE: KEY SWITCH
DWN		VIEW:	PART NO.: XKB5858-W-TP-75
CHKD		UNIT: mm/in	DWG NO.:
APPD		SIZE: A4	
XKB INDUSTRIAL PRECISION CO., LIMITED			WEIGHT
			SHEET
			REVISIC
			1/1
			A0

www.helloxkb.com www.helloxkb.cn www.xk-dg.cn