



Schottky Barrier Diode	Specification Features
<p><u>SOD882</u></p>  <p>SOD882 Package</p>  <p>Marking :F</p>	<ul style="list-style-type: none"> § Low Forward Voltage Drop § Small Surface Mounting Type (DFN1006) § RoHS Compliant § Green EMC § Matte Tin(Sn) Lead Finish § Band Indicates Cathode § Weight: approx. 0.001g

Absolute Maximum Ratings $T_A = 25\text{ C}$ unless otherwise noted

Parameter	Symbol	Value	Unit
DC reverse voltage	V_R	30	V
Average rectifier forward current	I_O	200	mA
Forward current surge peak(60Hz · 1cyc)	I_{FSM}	500	mA
Junction temperature	T_j	125	°C
Storage temperature	T_{stg}	-40 to +125	°C

Electrical Characteristics $T_A = 25\text{ C}$ unless otherwise noted

Characteristic	Symbol	Min	Typ	Max	Unit	Condition
Forward voltage	V_F	--	--	0.50	V	(IF=200mA)
		--	--	0.40		(IF=100mA)
		--	--	0.38		(IF=20mA)
		--	--	0.35		(IF=10mA)
Reverse current	I_R	--	--	30	uA	$V_R=10V$

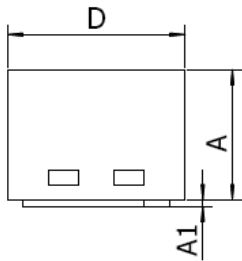
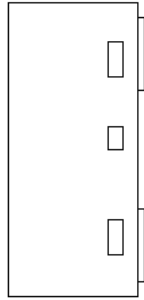
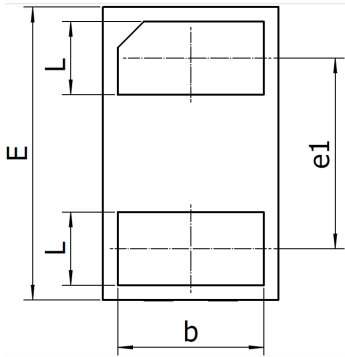

Typical Soldering Pattern(mm):

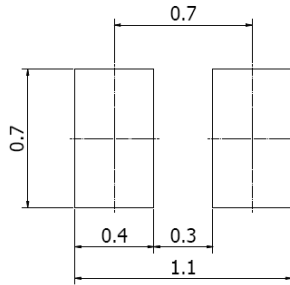

DIM	MILLIMETERS		INCHES	
	MIN	MAX	MIN	MAX
A	0.46	0.50	0.018	0.020
A1	---	0.03	---	0.001
b	0.45	0.55	0.018	0.022
D	0.55	0.65	0.022	0.026
E	0.95	1.05	0.037	0.041
e1	Typ. 0.65		Typ. 0.026	
L	0.20	0.30	0.008	0.012