

## Surface Mount Transient Voltage Suppressors

High temperature stability and high reliability conditions



DO-218AB



### FEATURES

- Junction passivation optimized design passivated anisotropic rectifier technology.
- $T_J = 175^\circ\text{C}$  capability suitable for high reliability and automotive requirement.
- Available in uni-directional polarity only.
- Low leakage current.
- Low forward voltage drop.
- High surge capability.
- Meets ISO16750-2 surge specification(varied by test condition).
- Meets MSL-1, per J-STD-020, LF maximum peak of  $245^\circ\text{C}$ .
- AEC-Q101 qualified.
- Compliant to RoHS directive 2011/65/EU and in accordance to WEEE 2002/96/EC.

### TYPICAL APPLICATIONS

Use in sensitive electronics protection against voltage transients induced by inductive load switching and lighting, especially for automotive load dump protection application.

### MECHANICAL DATA

**Case:** DO-218AB

Molding compound meets UL 94V-0 flammability rating

Base P/NHE3-RoHS-compliant, AEC-Q101 qualified

**Terminals:** Matte tin plated leads, solderable per J-STD-002

PRIMARY CHARACTERISTICS	
$V_R$	10V to 36V
$P_{PP}$ (10/1000 $\mu\text{s}$ )	4600W
$P_{PP}$ (10/10000 $\mu\text{s}$ )	3600W
$P_D$	6W
$I_{FSM}$	600A
$T_{Jmax}$	$175^\circ\text{C}$
Package	DO-218AB

MAXIMUM RATINGS( $T_C=25^\circ\text{C}$ , RH=45%-75%, unless otherwise noted)			
Parameter	Symbol	Value	Unit
Peak pulse power dissipation on 10/1000 $\mu\text{s}$ waveform	$P_{PP}$	4600	Watts
Peak pulse power dissipation on 10/10000 $\mu\text{s}$ waveform		3600	Watts
Power dissipation on infinite heat sink at $T_C=25^\circ\text{C}$	$P_D$	6.0	Watts
Peak pulse current with 10/1000 $\mu\text{s}$ waveform	$I_{PPM}^{(1)}$	See next table	Amps
Peak forward surge current, 8.3ms single half sine-wave	$I_{FSM}$	600	Amps
Operating junction and storage temperature range	$T_J, T_{STG}$	-55 to +175	$^\circ\text{C}$
Typical thermal resistance, junction to case	$R_{\theta JC}$	0.95	$^\circ\text{C/W}$

### Note

(1) Non-repetitive current pulse derated above  $T_A=25^\circ\text{C}$

ELECTRICAL CHARACTERISTICS								
Part Number	V <sub>R</sub>	I <sub>T</sub>	I <sub>R</sub> @V <sub>R</sub>		V <sub>BR</sub> @I <sub>T</sub>		V <sub>C</sub> @I <sub>PP</sub>	I <sub>PP</sub>
Uni-polar	V	mA	µA@25°C	µA@175°C	min(V)	max (V)	V	A
SM6S10A	10.0	5	5	250	11.1	12.3	17.0	271.0
SM6S11A	11.0	5	5	150	12.2	13.5	18.2	253.0
SM6S12A	12.0	5	5	150	13.3	14.7	19.9	231.0
SM6S13A	13.0	5	5	150	14.4	15.9	21.5	214.0
SM6S14A	14.0	5	5	150	15.6	17.2	23.2	198.0
SM6S15A	15.0	5	5	150	16.7	18.5	24.4	189.0
SM6S16A	16.0	5	5	150	17.8	19.7	26.0	177.0
SM6S17A	17.0	5	5	150	18.9	20.9	27.6	167.0
SM6S18A	18.0	5	5	150	20.0	22.1	29.2	158.0
SM6S20A	20.0	5	5	150	22.2	24.5	32.4	142.0
SM6S22A	22.0	5	5	150	24.4	26.9	35.5	130.0
SM6S24A	24.0	5	5	150	26.7	29.5	38.9	118.0
SM6S26A	26.0	5	5	150	28.9	31.9	42.1	109.0
SM6S28A	28.0	5	5	150	31.1	34.4	45.4	101.0
SM6S30A	30.0	5	5	150	33.3	36.8	48.4	95.0
SM6S33A	33.0	5	5	150	36.7	40.6	53.3	86.0
SM6S36A	36.0	5	5	150	40.0	44.2	58.1	79.0

**Note:**

①. For all types maximum V<sub>F</sub>=1.9V at I<sub>F</sub>=100A measured on 8.3ms single half sine-wave or equivalent square wave, duty cycle=4 pulses per minute maximum.

②.Surge waveform:10/1000µs

V<sub>R</sub>: Stand-off voltage -- Maximum voltage that can be applied

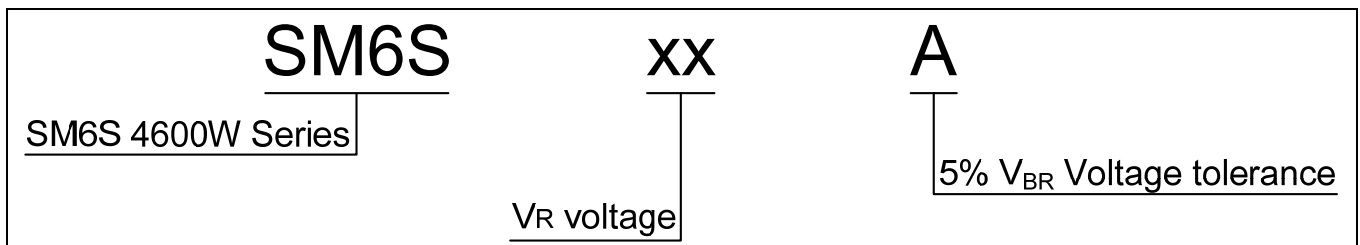
V<sub>BR</sub>: Breakdown voltage

V<sub>C</sub>: Clamping voltage -- Peak voltage measured across the suppressor at a specified I<sub>PP</sub>

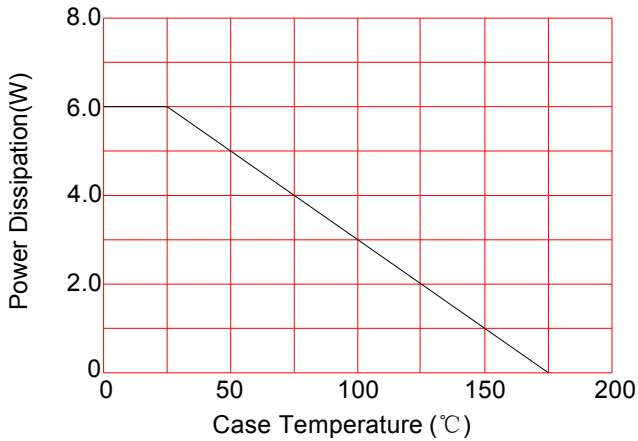
I<sub>R</sub>: Reverse leakage current

I<sub>T</sub>: Test current

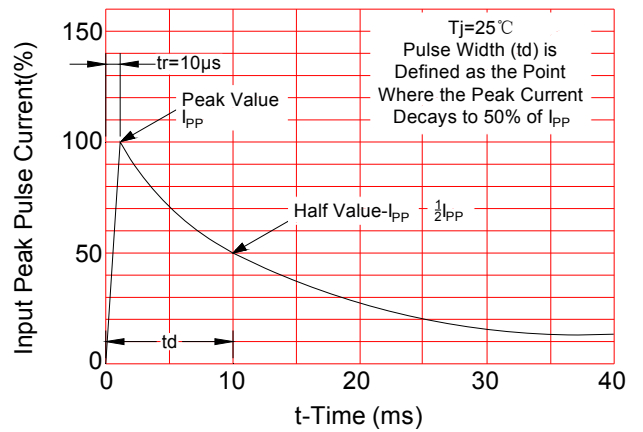
**ORDERING INFORMATION**



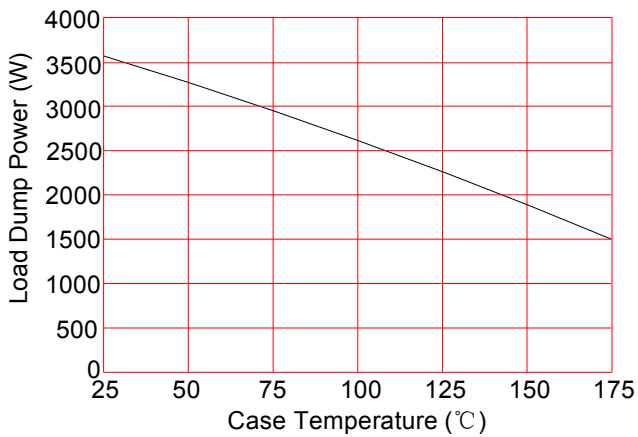
**RATINGS AND CHARACTERISTICS CURVES** ( $T_A=25^{\circ}\text{C}$ , unless otherwise noted)



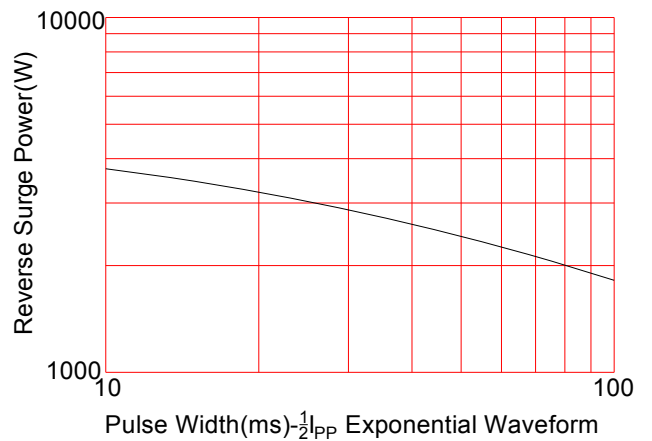
**FIG.1: Power Derating Curve**



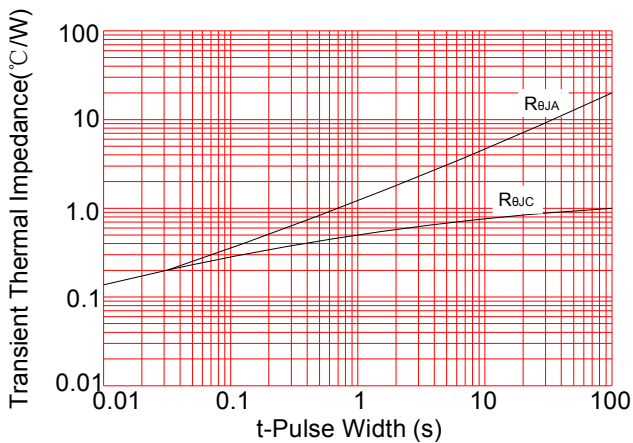
**FIG.2: Pulse Waveform**



**FIG.3: Load Dump Power Characteristics (10ms Exponential Waveform)**

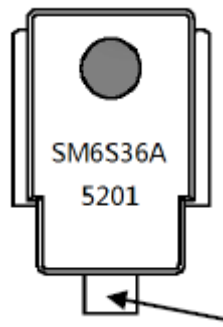


**FIG.4: Reverse Power Capability**



**FIG.5: Typical Transient Thermal Impedance**

**MARKING**



**SM6S36A:** Device marking code

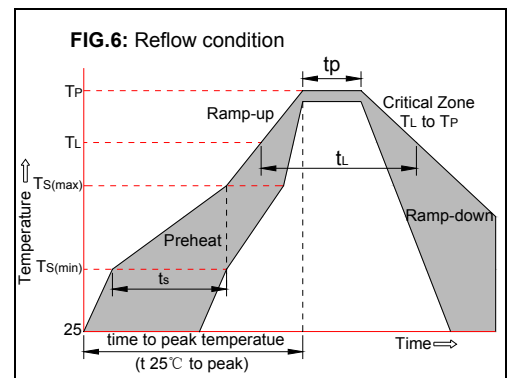
**5201:** “5” --2015 (year)

“2” --2 (month)

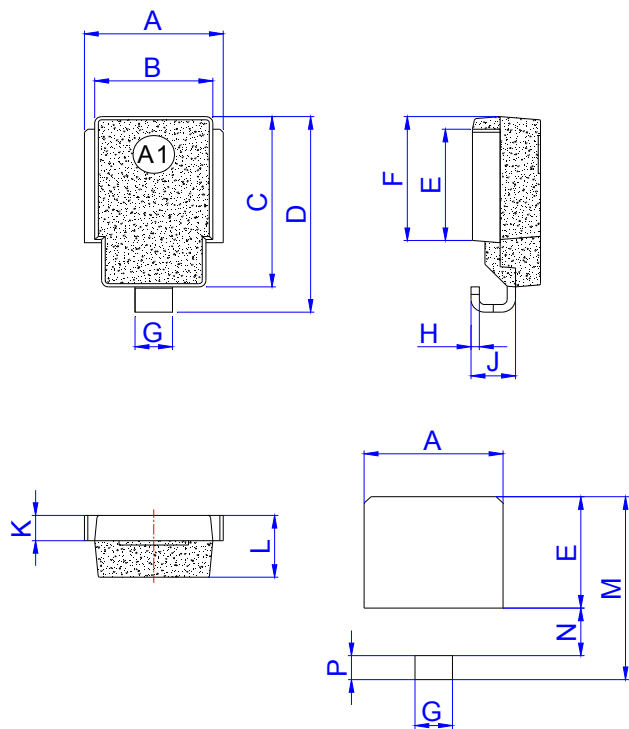
“01” -- (lot)

**SOLDERING PARAMETERS**

Reflow Condition		Pb-Free assembly (see FIG.6)
Pre Heat	-Temperature Min ( $T_{s(min)}$ )	+150°C
	-Temperature Max( $T_{s(max)}$ )	+200°C
	-Time (Min to Max) ( $t_s$ )	60-180 secs.
Average ramp up rate (Liquidus Temp ( $T_L$ )to peak)		3°C/sec. Max
$T_{s(max)}$ to $T_L$ - Ramp-up Rate		3°C/sec. Max
Reflow	-Temperature( $T_L$ )(Liquidus)	+217°C
	-Temperature( $t_L$ )	60-150 secs.
Peak Temp ( $T_p$ )		+260(+0/-5)°C
Time within 5°C of actual Peak Temp ( $t_p$ )		20-40secs.
Ramp-down Rate		6°C/sec. Max
Time 25°C to Peak Temp ( $T_p$ )		8 min. Max
Do not exceed		+260°C



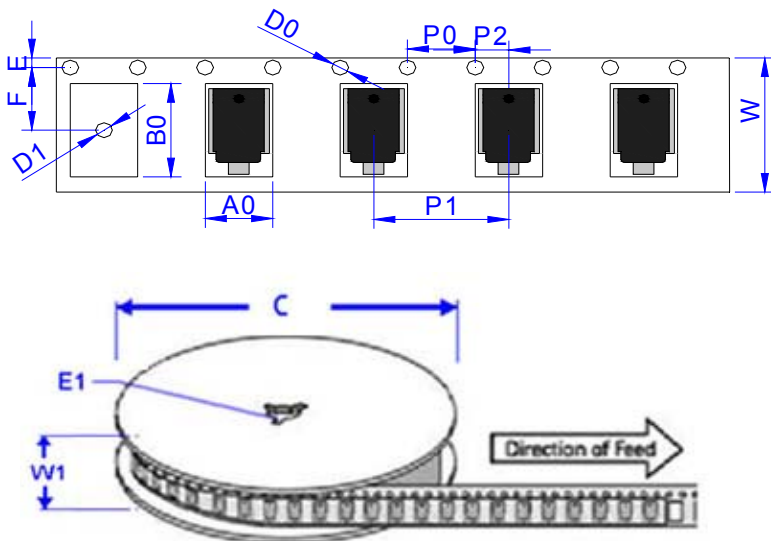
PACKAGE MECHANICAL DATA



DO-218AB

Ref.	Dimensions			
	Millimeters		Inches	
	Min.	Max.	Min.	Max.
A	9.5	10.5	0.374	0.413
B	8.3	8.7	0.327	0.342
C	13.3	13.7	0.524	0.539
D	15.0	16.0	0.592	0.628
E	8.5	9.1	0.335	0.358
F	9.5	10.1	0.374	0.398
G	2.4	3.0	0.094	0.118
H	0.5	0.7	0.020	0.028
J	2.7	3.7	0.106	0.146
K	1.9	2.1	0.075	0.083
L	4.7	5.1	0.185	0.201
M	14.2	14.8	0.559	0.583
N	3.5	4.1	0.138	0.161
P	1.6	2.2	0.063	0.087

TAPE AND REEL SPECIFICATION-DO-218AB



Ref.	Dimensions	
	Millimeters	Inches
A0	10.80 ± 0.3	0.425± 0.012
B0	16.13 ± 0.3	0.635 ± 0.012
C	330.0 ± 0.3	13.0 ± 0.012
D0	1.55 ± 0.2	0.061 ± 0.008
D1	1.55 ± 0.2	0.061± 0.008
E	1.75 ± 0.2	0.069 ± 0.008
E1	13.30 ± 0.2	0.524 ± 0.008
F	11.50 ± 0.2	0.453 ± 0.008
P0	4.00 ± 0.2	0.157 ± 0.008
P1	16.00 ± 0.2	0.630 ± 0.008
P2	2.00 ± 0.2	0.079 ± 0.008
W	24.00 ± 0.2	0.945 ± 0.008
W1	25.85 ± 0.2	1.018 ± 0.008

ORDERING INFORMATION				
PART No.	UNIT WEIGHT (g) typ	REEL (PCS)	PER CARTON (PCS)	DESCRIPTION
SM6SxxA	2.985	750	3000	13 inch reel pack

Information furnished in this document is believed to be accurate and reliable. However, Jiangsu JieJie Microelectronics Co.,Ltd assumes no responsibility for the consequences of use without consideration for such information nor use beyond it.

Information mentioned in this document is subject to change without notice, apart from that when an agreement is signed, Jiangsu JieJie complies with the agreement.

Products and information provided in this document have no infringement of patents. Jiangsu JieJie assumes no responsibility for any infringement of other rights of third parties which may result from the use of such products and information.

This document is the 2.2nd version which is made in 27-Apr.-2019. This document supersedes and replaces all information previously supplied.

 is a registered trademark of Jiangsu JieJie Microelectronics Co.,Ltd.

Copyright©2019 Jiangsu JieJie Microelectronics Co.,Ltd. Printed All rights reserved.