

MAPX	MODIFICATION	DATE
------	--------------	------

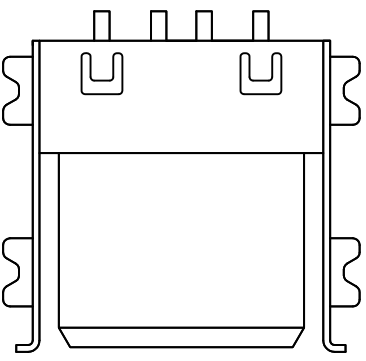
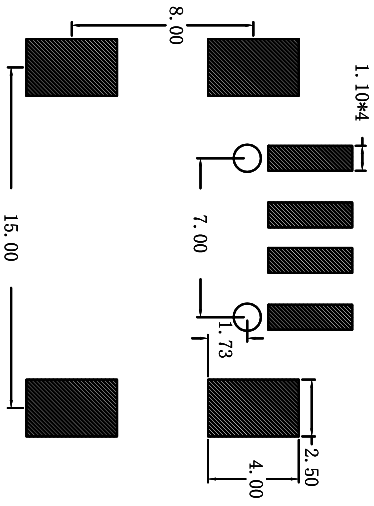
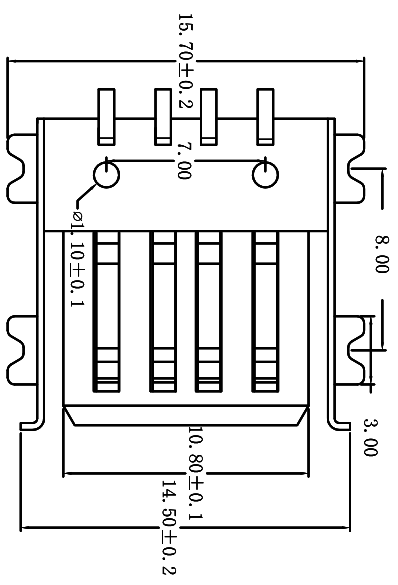
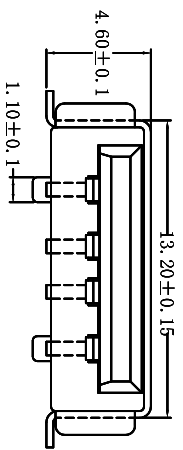
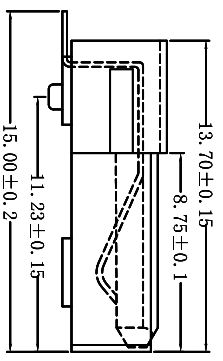

规格说明: Specifications:

电气特性: Electrical:

- 额定电流: Current Rating
1.5A/contact terminal
- 额定电压: Voltage Rating
30V DC
- 接触阻抗: Contact Resistance
30 milliohms MAX
- 耐压: Dielectric Withstanding Voltage:
500 V AC AT Sea Level
- 绝缘阻抗: Insulation Resistance:
1000MEGA ohms MIN

物理性能: Mechanical:

- 插拔力: Connector Mate and Umate Force
Mate force: 3.75kgf (MAX)
Umate force: 1.02kgf (MIN)
- 端子保持力: Terminal Retention
1.2kgf (MIN)

原材料: Material:

- 塑胶: Housing:
Hing Temperature Thermoplastics,
U1 94V-0 PBT/LCP White/Black
- 端子: Contact: Copper Alloy C2680
- 外壳: Shell: Copper Alloy C2680/SPCC

- 端子: Contact: Plated Gold in Mating Area;
Tin On Solder Tails
- 外壳: Shell:
Nickel Plating

深圳市精拓金电子有限公司

产品图
PRODUCT CHART DWG

公差一览表

TOLERANCE	UNLESS OTHERWISE SPECIFIED
X	±0.15
X	±0.10
.XX	±0.05
.XXX	±0.03

单位	MM	制图	许密强	制图料号
UNITS	MM	DRAWING	审核	PRODUCT PART NO.
比例	1:1	SCALE	审核	PRODUCT NO.
日期	2016-09-09	DATE	核准	角法
			黄国荣	版本
			APPRO	VER

AF超薄SMT全贴

A0

1 2 3 4 7 8 9 10