

MAPX	MODIFICATION	DATE
------	--------------	------

NOTES:

- Housing: Thermoplastics
- Contact: Copper Alloy
- Shell: Copper Alloy/Steel
- Voltage Current Rating: 1.5 AMP. 30V AC
- Insulation Resistance: 1000M $\Omega$  Min.
- Contact Resistance: 30 M $\Omega$  Max.
- Dielectric Withstanding Voltage: 500W AC
- Temperature Range: -55 $^{\circ}$  C to +85 $^{\circ}$  C
- Insulator color: Black/White
- Plastic material: PBT/LCP
- Shell finish: Nickel plated/Tin-Lead plated
- Contact finish:
  - 01: Selective Gold Flash
  - 02: Selective Gold 3U"
  - 03: Selective Gold 5U"
  - 04: Selective Gold 15U"
  - 05: Selective Gold 30U"

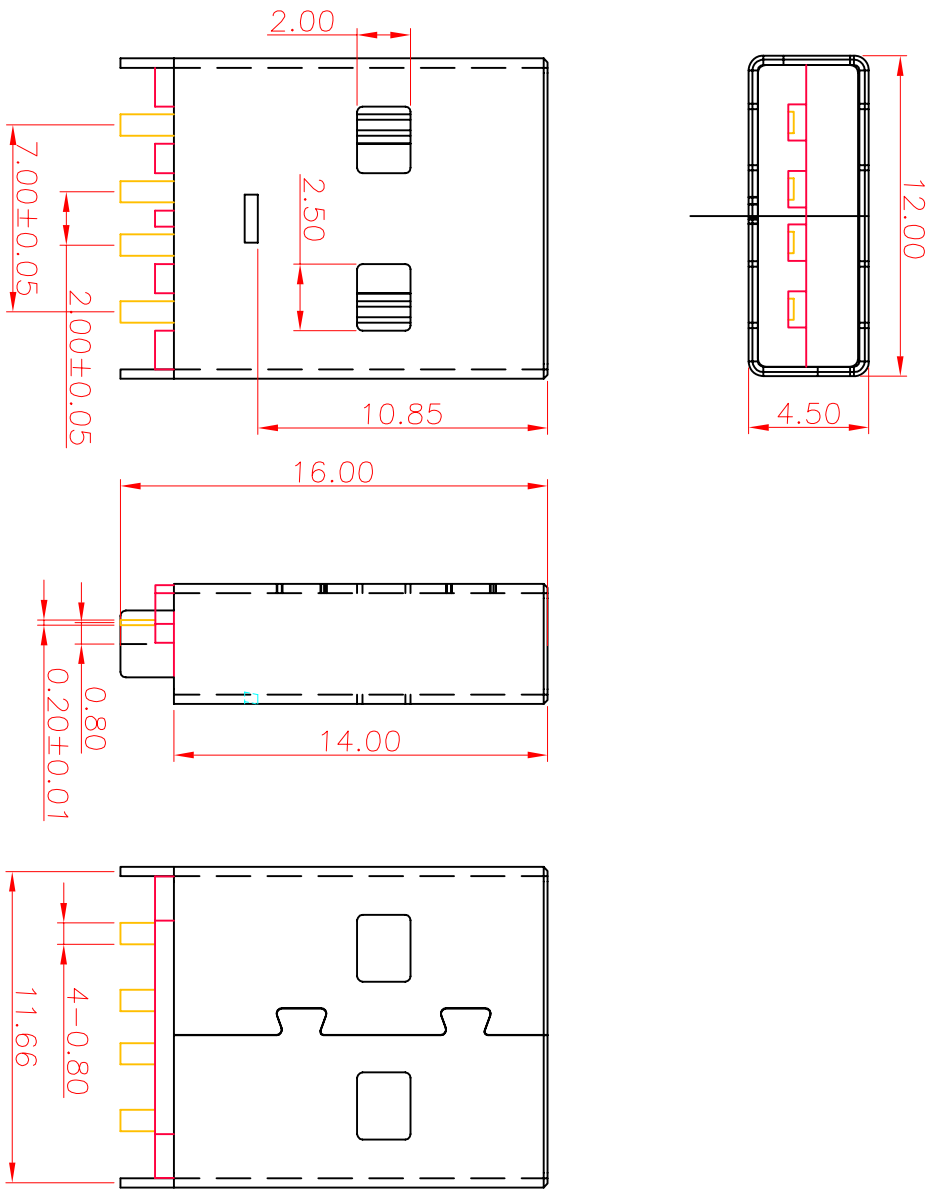

产品图  
PRODUCT CHART DWG  
公差一览表  
TOLERANCE TABLE

公差一览表 TOLERANCE TABLE	公差 TOLERANCE	其他公差 OTHER TOLERANCE
X	±0.25	X
X	±0.20	X
XX	±0.15	XX
XXX	±0.10	XXX
角度 ANGLE	±45 $^{\circ}$	
比例 SCALE	1:1	
日期 DATE	2012.04.02	

单位 UNITS	MM	制图 DRAWING	Z-Y-B	制图料号 PRODUCT PART NO.	USB A/M短体焊板式0.35
审核 CHKD		核准 APPD		版本 VER	A0

深圳市精拓金电子有限公司

1 2 3 4 5 6 7 8 9 10