

| REVISIONS |         |          |                 |            |        |
|-----------|---------|----------|-----------------|------------|--------|
| REV.      | ECN NO. | LOCATION | DESCRIPTION     | DATE       | DESIGN |
| A0        | N/A     |          | INITIAL RELEASE | 2024.03.27 |        |

Current rating: 3A AC/DC  
 额定电流: 3A AC/DC  
 Temperature range: -40°C ~ +125°C  
 温度范围: -40°C ~ +125°C

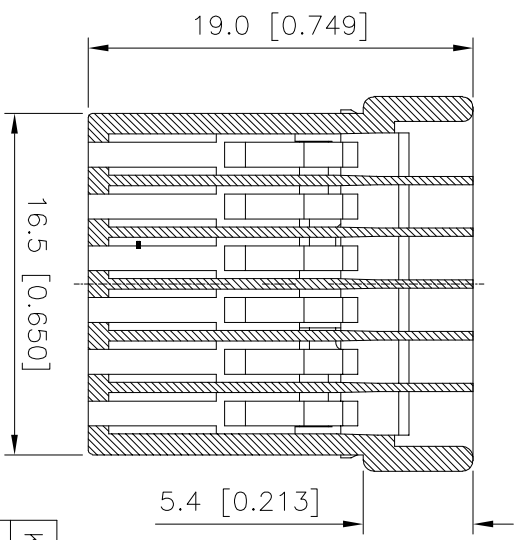
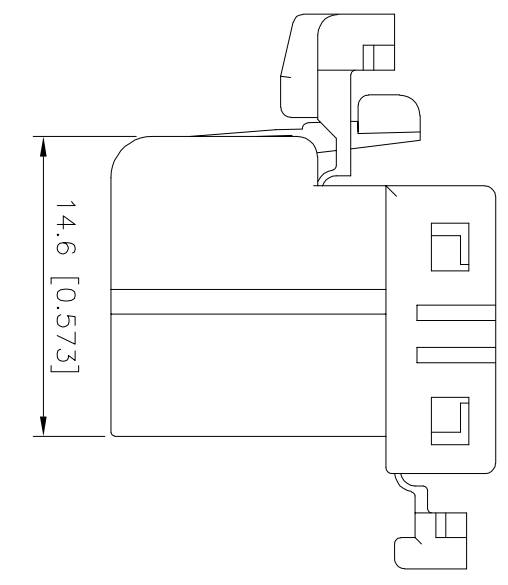
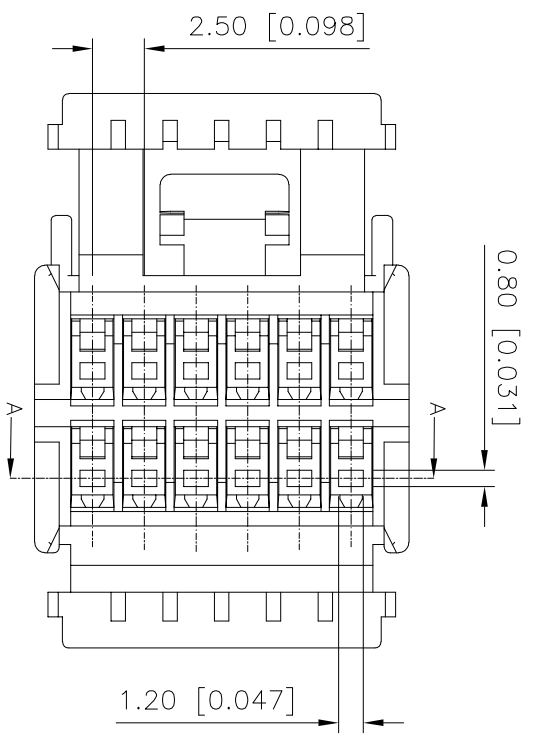

K 174051 H M - 2xxx - N0  
 ① ② ③ ④ ⑤ ⑥

- 1.K: XKBTEK-Car Connector
- 2.XKB Series No
- 3.Category:H-Housing
- 4.Welding Board Angle:M-Male Housing
- 5.Row No.Pin No:2xxx-2x06 Pin
- 6.Material:N0-PA66 UL94V-0

|                   |          |                    |                       |
|-------------------|----------|--------------------|-----------------------|
| K174051HM-2x06-N0 | PA66     | K174051W           | K174051T              |
| PART NO           | Material | Suitable XKB Wafer | Suitable XKB Terminal |

SECTION:A-A

| ANGULAR | ±5°   |
|---------|-------|
| X.      | ±0.40 |
| X.X     | ±0.30 |
| X.XX    | ±0.20 |
| X.XXX   | ±0.15 |

UNSPECIFIED TOLERANCES

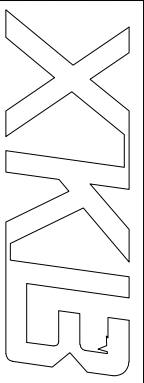

|          |    |             |                             |
|----------|----|-------------|-----------------------------|
| DESIGN   | 桑葚 | VIEW:       | MODEL TYPE:                 |
| CHECKED  |    | UNIT: mm/in | 2.5mm Automobile connector  |
| APPROVED |    | SIZE: A4    | PART NO.: K174051HM-2x06-N0 |
|          |    |             | DWG NO.:                    |

XKB INDUSTRIAL PRECISION CO., LIMITED