

Recommended P.C.B Layout(Top Side)
P.C.B Thickness = 1.20-1.60mm
(Tolerance=±0.05)

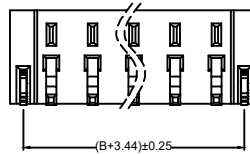
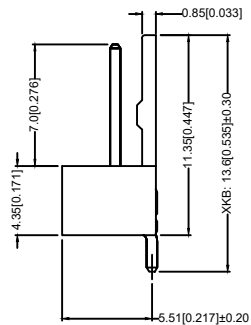

X2510 W R S-04 - 9T SN

- ① ② ③ ④ ⑤ ⑥ ⑦

- ① Series No.
- ② Category: W-WAFER
- ③ Welding Board Angle: R-Right Angle 90°
- ④ Welding Way: S-SMT
- ⑤ Row No.-Pin No. XX-Single row
- ⑥ Material: 9T-PA9T UL94-V0
- ⑦ Planting Category: SN-Bright tin plating 70-120u"

Specifications:

规格:

- Voltage rating:250V AC/DC
- 额定电压: 250V AC/DC
- Current rating: 4.0A
- 额定电流: 4.0A
- Withstanding voltage: 1000V AC/minute
- 耐压电压: 1000V AC/minute
- Temperature range: -25°C ~ +85°C
- 温度范围: -25°C ~ +85°C
- Insulation resistance: ≥1000MΩ
- 绝缘电阻: ≥1000MΩ
- Contact resistance: ≤0.02Ω
- 接触电阻: ≤0.02Ω

Poles	Dimensions(mm)			
	A	B	C	D
2	7.62	2.54	-	-
3	-	-	-	-
4	12.70	7.62	-	-
5	15.24	10.16	-	-
6	-	-	-	-
7	-	-	-	-
8	-	-	-	-
9	-	-	-	-

X2510WRS-XX-9TSN	PA9T UL 94V-0	Brass	Tin Plating Fog	X2510H
PART NO	Material	Material(Pin)	Finish(Pin)	Mates With XKB Housing

REVISIONS					UNSPECIFIED TOLERANCES			XKB INDUSTRIAL PRECISION CO.,LIMITED		
ΔX					ANGULAR	±5°	DSND	DATE	SCALE: N/A	MODEL TYPE:
ΔX					L ≤ 4	±0.2	DWN	DATE	VIEW:	PART NO.:
ΔX					4 < L ≤ 16	±0.3	CHKD	DATE	UNIT: mm/in	2.54 mm Crimp Style Connectors
MARK	DESCRIPTION	DATE	REVISED	APPROVED	16 < L ≤ 63	±0.4	APPD	DATE	SIZE: A4	DWG NO.:
					L > 63	±0.5				X2510WRS-XX-9TSN
										WEIGHT
										1.0g
										SHEET
										1/1
										REVISION
										A0

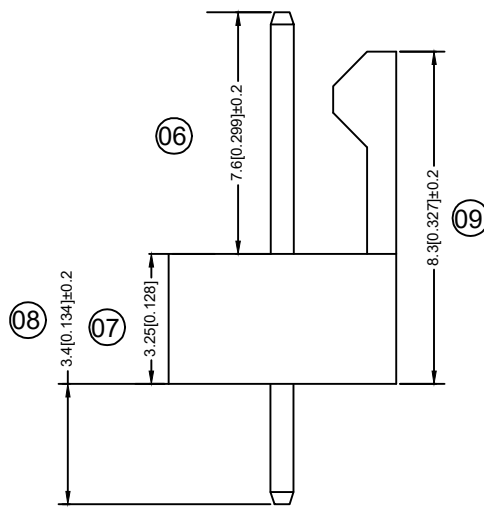
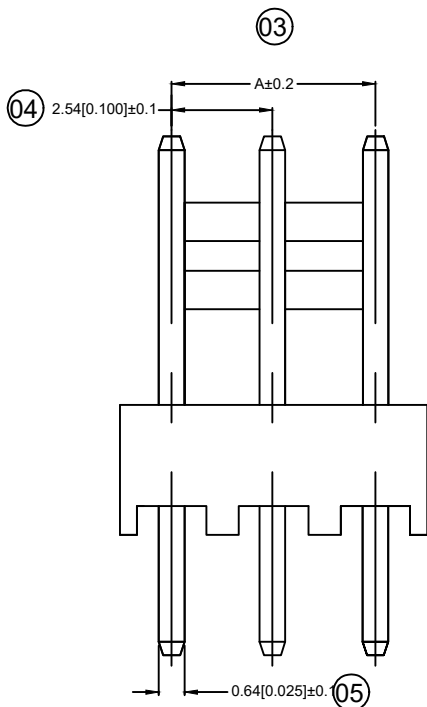
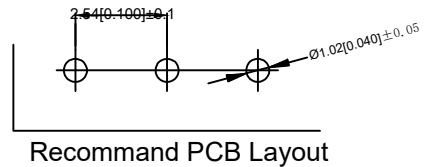
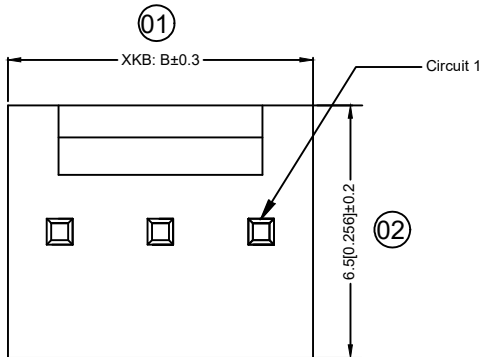

X2510 W V X- XX SP- N0SN XX
 ① ②③④⑤ ⑥ ⑦⑧⑨

- ① Series No.
- ② Category:
W-wafer
- ③ Welding Board Angle:
R90
- ④ Welding Way:
Blank-DIP
- ⑤ Row No.-Pin No.
XX-Single row
- ⑥ Special NO.
SP-Short back
- ⑦ Material:
NO-PA66 94V-0

Planting Category:
 V-All Gold-Plated
 01-Gold Flash 02-2U 03-3U 05-5U
 10-10U 15-15U 30-30U 50-50U
 SN-Bright tin plating 70-120U
 SN-Bright tin plating 120U Min
 SW-Fog Tin plating

- ⑨ Color:
Blank-natural color

Specifications:

规格:
 Voltage rating:250V AC/DC
 额定电压: 250V AC/DC
 Current rating:
 额定电流:
 Withstanding voltage: 800V AC/minute
 耐压电压: 800V AC/minute
 Temperature range:-25℃~+85℃
 温度范围: -25℃~+85℃
 Insulation resistance:≥1000MΩ
 绝缘电阻: ≥1000MΩ
 Contact resistance: ≤10mΩ
 接触电阻:≤10mΩ
 After environment testing: ≤20mΩ
 环境试验后: ≤20mΩ

Poles	Dimensions (mm)	
	A	B
2	2.54	5.08
3	5.08	7.62
4	7.62	10.16
5	10.16	12.70
6	12.70	15.24
7	15.24	17.78
8	17.78	20.32
9	20.32	22.86
10	22.86	25.40
11	25.40	27.94
12	27.94	30.48
13	30.48	33.02
14	33.02	35.56
15	35.56	38.10
16	38.10	40.64
17	40.64	43.18
18	43.18	45.72
19	45.72	48.26
20	48.26	50.80

X2510WV-XXSP-N0SN	Nylon 66 UL94V-0	Brass	Tin-Plated	X2510H
PART NO	Material	Material(Pin)	Finist(Pin)	

REVISIONS					UNSPECIFIED TOLERANCES	DSND	DATE	SCALE: N/A	MODEL TYPE:
ΔX					ANGLAR ±5°	DWN	DATE	VIEW:	PART NO.:
ΔX					L ≤ 4 ±0.2	CHKD	DATE	UNIT: mm/in	2.54 mm Crimp Style Connectors
ΔX					4 < L ≤ 16 ±0.3	APPD	DATE	SIZE: A4	DWG NO.:
MARK	DESCRIPTION	DATE	REVISED	APPROVED	16 < L ≤ 63 ±0.4	XKB INDUSTRIAL PRECISION CO., LIMITED			X2510WV-XXSP-N0SN
					L > 63 ±0.5	WEIGHT			SHEET
www.xk-dg.cn www.helloxkb.com www.helloxkb.cn						1.0g			1/1
						REVISION			A0

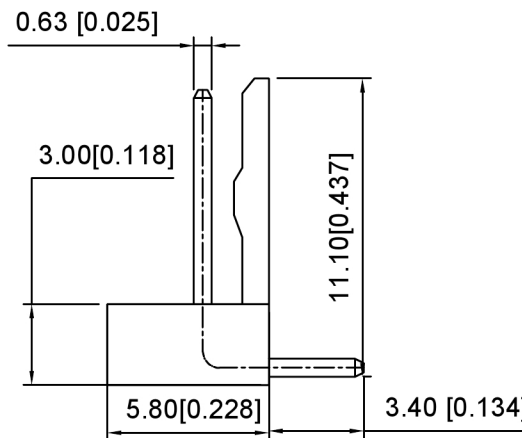
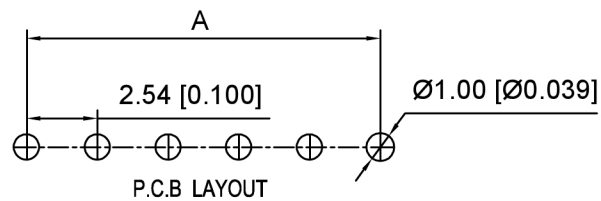
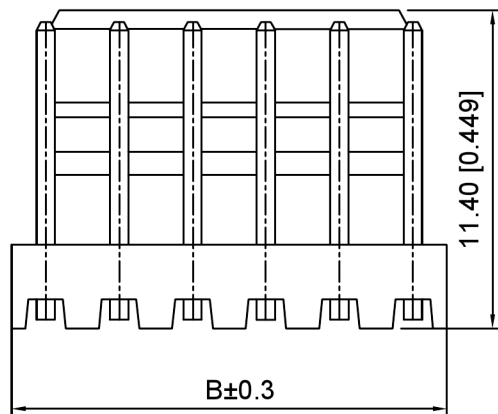
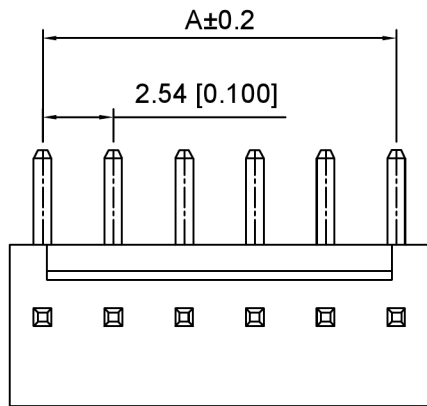

Specifications:
 规格:
 Voltage rating:250V AC/DC
 额定电压: 250V AC/DC
 Current rating:3A AC/DC
 额定电流: 3A AC/DC
 Withstanding voltage:1000V AC/minute
 耐受电压: 1000V AC/分钟
 Temperature range:-25℃-+85℃
 温度范围: -25℃-+85℃
 Insulation resistance:≤10mΩ min
 绝缘电阻: ≤10mΩ min
 Contact resistance:20mΩ Max
 接触电阻: 20mΩ Max

X2510 W R -XX A -N0 SN
 ① ② ③ ④ ⑤ ⑥ ⑦

- 1.Series No
- 2.Category:W-Wafer
- 3.Welding Board Angle:R- 90°
- 4..Row No-Pin No:XX-02P~20P
- 5.TYPE:B
- 6.Material:N0-PA99 94V-0
- 7.Plating Category:SN-Bright Tin Plating

poles	Dimensions/mm	
	A	B
02	2.54	5.08
03	5.08	7.62
04	7.62	10.16
05	10.16	12.70
06	12.70	15.24
07	15.24	17.78
08	17.78	20.32
09	20.32	22.86
10	22.86	25.40
11	25.40	27.94
12	27.94	30.48
13	30.48	33.02
14	33.02	35.56
15	35.56	38.10

X2510WR-XXA-N0SN	N0-Nylon66	Brass	Tin-Plated	X2510H
PART NO	Material	Material(Pin)	Finish(Pin)	Suitable XKI Terminal

DSND	SCALE: N/A	MODEL TYPE: 2.54mm Crimp Style Connect
DWN	VIEW:	PART NO.: X2510WR-XXA-N0SN
CHKD	UNIT: mm/in	DWG NO.: X2510WR-XXA-N0SN
APPD	SIZE: A4	WEIGHT
		SHEET
		REVISIT

XKIB

XKB INDUSTRIAL PRECISION CO.,LIMITED

广东星坤科技股份有限公司

ΔX	日期
ΔX	日期
ΔX	日期
MARK	DESCRIPTION

文件工程章

REVISIONS	DATE	REVISED	APPROVED	UNSPECIFIED TOLERANCES
ANGLAR				±5°
L ≤ 4				±0.2
4 < L ≤ 16				±0.3
16 < L ≤ 63				±0.4
L > 63				±0.5

www.helloxkb.com www.helloxkb.cn www.xk-dg.cn

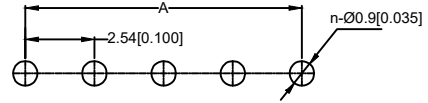
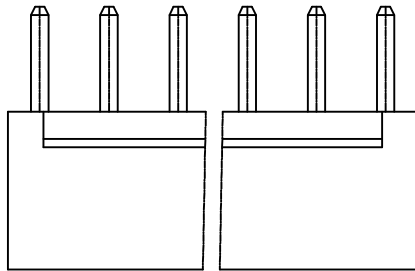
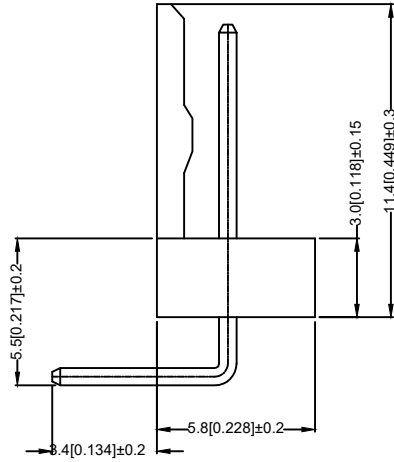
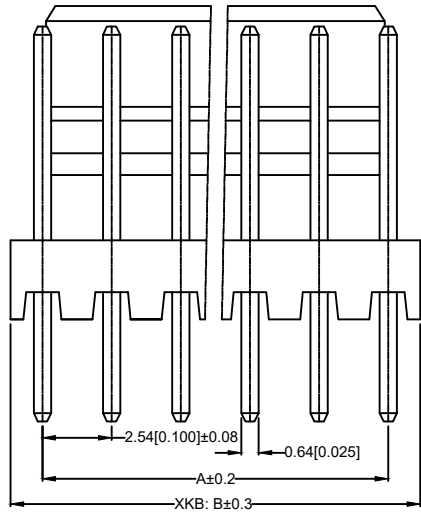

PCB
PCBLAYOUT

Specifications:

规格:
 Voltage rating:250V AC/DC
 额定电压: 250V AC/DC
 Current rating: 3A AC / DC
 额定电流: 3A AC / DC
 Withstanding voltage: 1000V AC/minute
 耐压电压: 1000V AC/minute
 Temperature range:-25℃~+85℃
 温度范围: -25℃~+85℃
 Insulation resistance:≥1000MΩ
 绝缘电阻: ≥1000MΩ
 Contact resistance: ≤10mΩ
 接触电阻: ≤10mΩ
 After environment testing: ≤20mΩ
 环境试验后: ≤20mΩ

X2510 W R - XX - N0 SN

- ① Series No.
- ② Category: W-WAFER
- ③ Welding Board Angle: R-90°
- ④ Row No.-Pin No. XX-Single Row
- ⑤ Material: N0-PA66 94V-0
- ⑥ Planting Category SN-Bright Tin Plating

Poles	Dimensions(mm)		Poles	Dimensions(mm)	
	A	B		A	B
2	2.54	5.08	10	22.86	25.4
3	5.08	7.62	11	25.4	27.94
4	7.62	10.16	12	27.94	30.48
5	10.16	12.70	13	30.48	33.02
6	12.70	15.24	14	33.02	35.56
7	15.24	17.78	15	35.56	38.10
8	17.78	20.32			
9	20.32	22.86			

X2510WR-XX-N0SN	Nylon 66 UL 94V-0	Brass	Tin-Plated	X2510H
PART NO	Material	Material(Pin)	Finish(Pin)	Mates With XKB Housing

REVISIONS					UNSPECIFIED TOLERANCES	DSND	DATE	SCALE: N/A	MODEL TYPE:
ΔX					ANGULAR				
					L ≤ 4			VIEW:	PART NO.:
ΔX					4 < L ≤ 16			UNIT: mm/in	2.54 mm Crimp Style Connectors
ΔX					16 < L ≤ 63			SIZE: A4	DWG NO.:
MARK	DESCRIPTION	DATE	REVISED	APPROVED	L > 63				X2510WR-XX-N0SN
						KXB INDUSTRIAL PRECISION CO., LIMITED			WEIGHT
									SHEET
									REVISION
									1.0g
									1/1
									A0

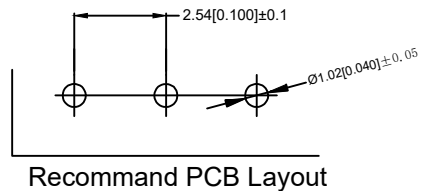
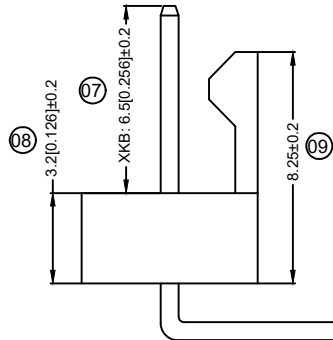
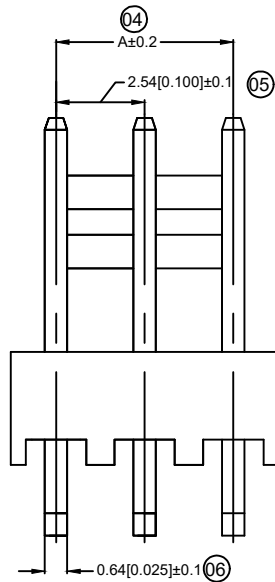
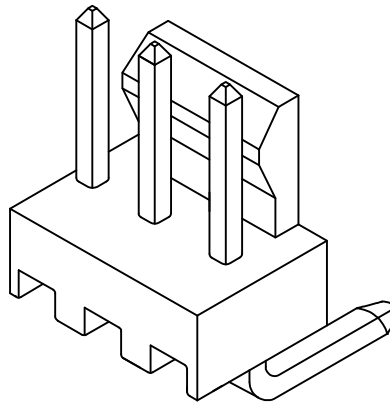
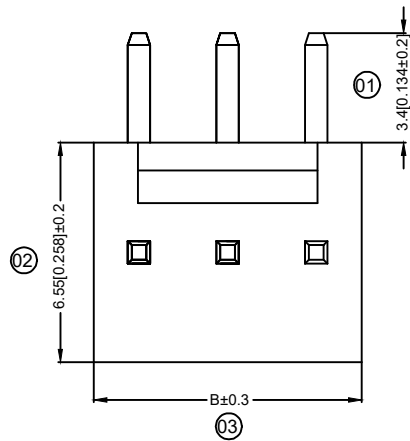

X2510 W R X- XX SP- N0SN XX

① ② ③ ④ ⑤ ⑥ ⑦ ⑧ ⑨

- ① Series No.
- ② Category:
W-wafer
- ③ Welding Board Angle:
R90
- ④ Welding Way:
Blank-DIP
- ⑤ Row No.-Pin No.
XX-Single row
- ⑥ Special NO.
SP-Short back
- ⑦ Material:
NO-PA66 94V-0

Planting Category:

V:All Gold-Plated
01-Gold Flash 02-2U 03-3U 05-5U
10-10U 15-15U 30-30U 50-50U
SN-Bright tin plating 70-120U
SN-Bright tin plating 120U Min
SW-Fog Tin plating

- ⑧ Color:
Blank-natural color

Specifications:

规格:
Voltage rating:250V AC/DC
额定电压: 250V AC/DC
Current rating:
额定电流:
Withstanding voltage: 800V AC/minute
耐压电压: 800V AC/minute
Temperature range:-25℃~+85℃
温度范围: -25℃~+85℃
Insulation resistance:≥1000MΩ
绝缘电阻: ≥1000MΩ
Contact resistance: ≤10mΩ
接触电阻: ≤10mΩ
After environment testing: ≤20mΩ
环境试验后: ≤20mΩ

Poles	Dimensions (mm)	
	A	B
2	2.54	5.08
3	5.08	7.62
4	7.62	10.16
5	10.16	12.70
6	12.70	15.24
7	15.24	17.78
8	17.78	20.32
9	20.32	22.86
10	22.86	25.40
11	25.40	27.94
12	27.94	30.48
13	30.48	33.02
14	33.02	35.56
15	35.56	38.10
16	38.10	40.64
17	40.64	43.18
18	43.18	45.72
19	45.72	48.26
20	48.26	50.80

X2510WR-XXSP-N0SN	Nylon 66 UL94V-0	Brass	Tin-Plated	X2510H
PART NO	Material	Material(Pin)	Finist(Pin)	Mates With XKB Housing

REVISIONS					UNSPECIFIED TOLERANCES	DSND	DATE	SCALE: N/A	MODEL TYPE:
ΔX					ANGULAR			VIEW:	PART NO.:
ΔX					L ≤ 4				2.54 mm Crimp Style Connectors
ΔX					4 < L ≤ 16			UNIT: mm/in	DWG NO.:
MARK	DESCRIPTION	DATE	REVISED	APPROVED	16 < L ≤ 63			SIZE: A4	X2510WR-XXSP-N0SN
					L > 63				WEIGHT
									SHEET
									REVISION
									1.0g
									1/1
									A0

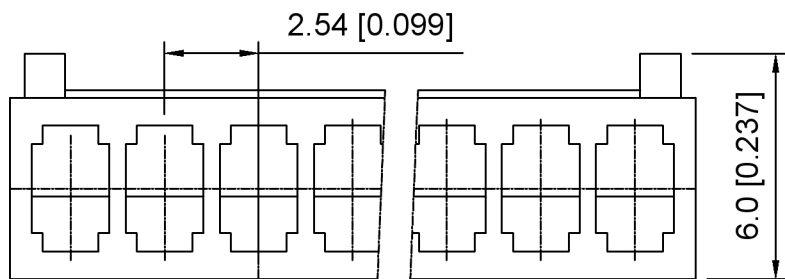
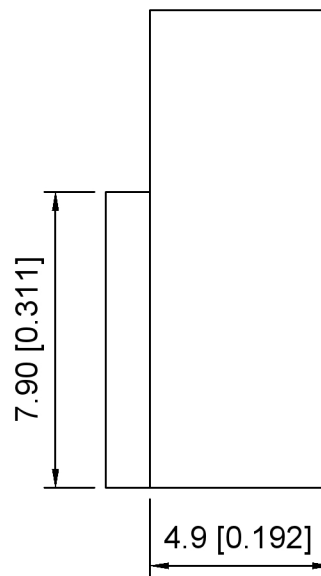
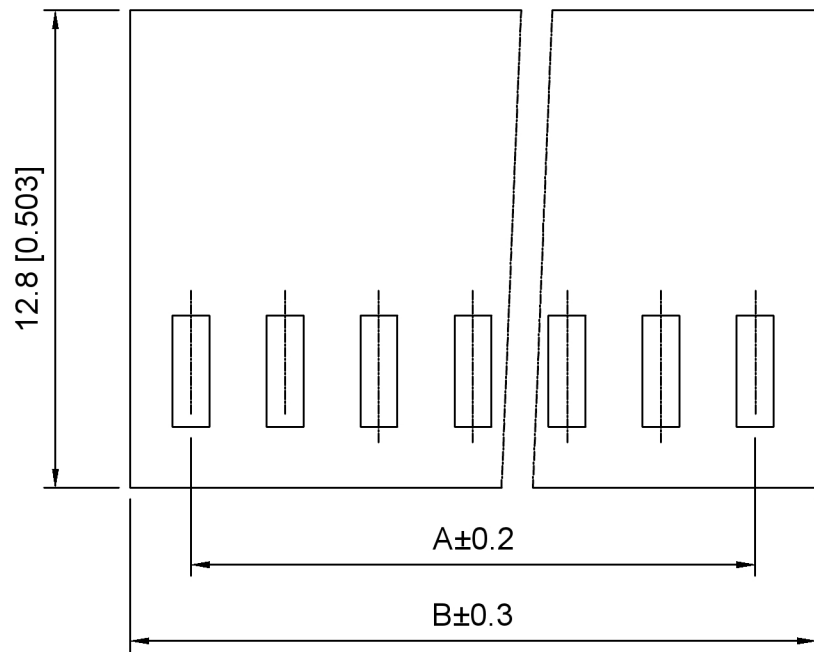

Specifications:

规格:

Voltage rating:250V AC/DC

额定电压: 250V AC/DC

Current rating:3A AC/DC

额定电流: 3A AC/DC

Withstanding voltage:1000V AC/minute

耐受电压: 1000V AC/分钟

Temperature range:-25℃~+85℃

温度范围: -25℃~+85℃

Insulation resistance:1000MΩ min

绝缘电阻: 1000MΩ Min

Contact resistance:20mΩ Max

接触电阻: 20mΩ Max

X2510 H - XX - N0

① ② ③ ④

1.Series No

2.Category:H-HSG

3.Row No.Pin No:XX-02~16P

4.Material:N0-PA66 UL94V-0

Poles	Dimensions(mm)		Poles	Dimensions(mm)	
	A	B		A	B
02	2.54	5.80	10	22.86	26.12
03	5.08	8.34	11	25.40	28.66
04	7.62	10.88	12	27.94	31.20
05	10.16	13.42	13	30.48	33.74
06	12.70	15.96	14	33.02	36.28
07	15.24	18.50	15	35.56	38.82
08	17.78	21.04	16	38.10	41.36
09	20.32	23.58			

X2510H-XX-N0	PA66	X2510W	X2510T
PART NO	Material	Suitable XKB Wafer	Suitable XKB Terminal

DSND	SCALE: N/A	MODEL TYPE: 2.54mm Crimp Style Connector
DWN	VIEW:	PART NO.: X2510H-XX-N0
CHKD	UNIT: mm/in	DWG NO.: X-X2510H-XX-N0
APPD	SIZE: A4	

XKLB

XKB INDUSTRIAL PRECISION CO.,LIMITED

WEIGHT	SHEET	REVISION
	1/1	A0

ANGLAR	±5°
L ≤ 4	±0.2
4 < L ≤ 16	±0.3
16 < L ≤ 63	±0.4
L > 63	±0.5

UNSPECIFIED TOLERANCES

广东星坤科技股份有限公司

DATE	DATE
DATE	DATE

MARK DESCRIPTION DATE REVISED APPROVED

文件工程章 REVISIONS

www.helloxkb.com www.helloxkb.cn www.xk-dg.cn

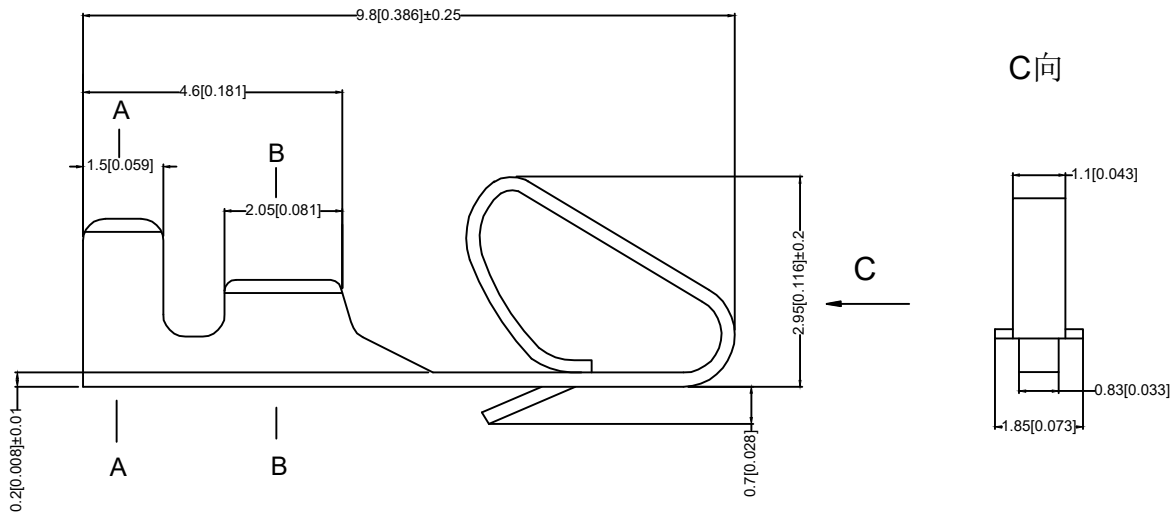

Specifications:

规格:
Voltage rating: 250V AC/DC
 额定电压: 250V AC/DC
Current rating: 3A AC / DC
 额定电流: 3A AC / DC
Withstanding voltage: 1000V AC/minute
 耐压电压: 1000V AC/minute
Temperature range: -25°C ~ +85°C
 温度范围: -25°C ~ +85°C
Insulation resistance: ≥1000MΩ
 绝缘电阻: ≥1000MΩ
Contact resistance: ≤10Ω
 接触电阻: ≤10Ω
After environmental testing: ≤20mΩ
 环境测试后: ≤20mΩ

A-A

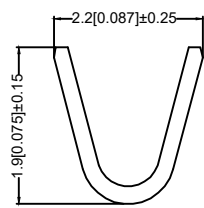

B-B

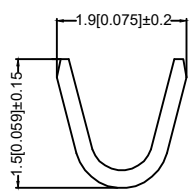

X2510 T-P SN

- ① ②③ ④
- ① Series Number.
 - ② Category: T-terminal
 - ③ Material: P-Phosphor bronze
 - ④ Planting style: SN-Bright tin plating

X2510T-PSN	Brass	AWG#22-28	1.57mm (Max)	Stamping Before Plating: 30u" Ni; 70u" Sn	X2510H
PART NO	Material	Wire Range	Insulation O.D.	Finish	Mates With XKB Housing

					ANGLAR	±5°	DSND		DATE		SCALE: N/A	MODEL TYPE:		
					L ≤ 4	±0.2	DWN		DATE		VIEW:	PART NO.:		
					4 < L ≤ 16	±0.3	CHKD		DATE		UNIT: mm/in	2.54 mm Crimp Style Connectors		
					16 < L ≤ 63	±0.4	APPD		DATE		SIZE: A4	DWG NO.:		
					L > 63	±0.5	KXB INDUSTRIAL PRECISION CO., LIMITED					X2510T-BSNXX		
					UNSPECIFIED TOLERANCES							WEIGHT	SHEET	REVISION
REVISIONS												1.0g	1/1	A0
MARK					DESCRIPTION		DATE	REVISED	APPROVED					
www.xk-dg.cn www.helloxkb.com www.helloxkb.cn														