

## Specifications :

- Voltage rating: 250V AC / DC
- Current rating: 5A AC / DC
- Withstanding voltage: 1000V AC/minute
- Temperature range: -25°C~+85°C
- Insulation resistance: ≥1000M Ω
- Contact resistance: ≤10m Ω
- After environmental testing : ≤20m Ω
- Mark "\*"Indicate Dimensions Need To Controlled In Emphasis

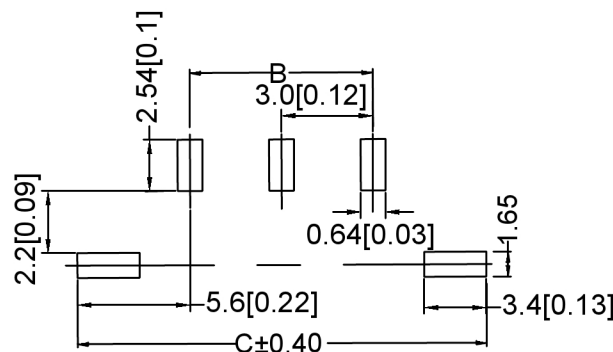
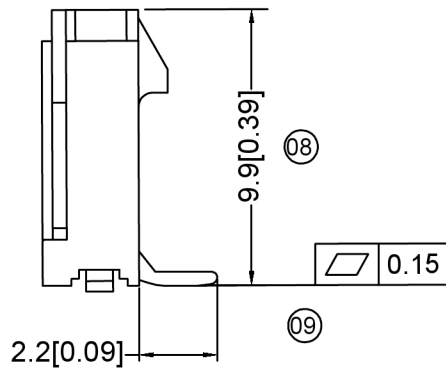
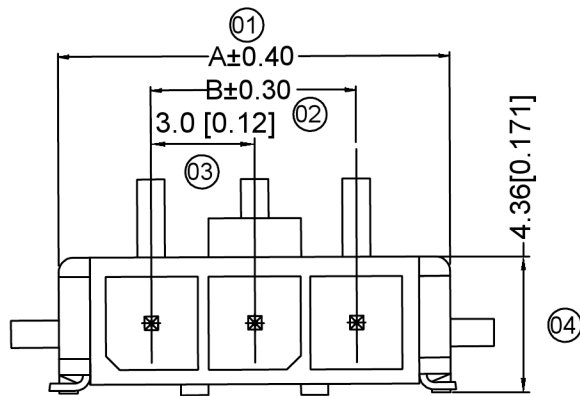

X3025 W V S- XX D-LP XX XX

① ② ③ ④ ⑤ ⑥ ⑦ ⑧ ⑨

- ① Series No.
- ② Category :  
W-wafer
- ③ Welding Board Angle:  
V-180°
- ④ Welding Way:  
S-SMT
- ⑤ Row No.-Pin No.  
XX-Single row
- ⑥ Special NO.  
D-Solder Tabs
- ⑦ Material:  
LP-LCP 94V-0
- ⑧ Planting Category:  
V\*\*;All Gold-Plated  
G\*\*;Gold-Plated Contact  
\*01-Gold Flash ; \*02-2U" ; \*03-3U" ; \*05-5U"  
\*10-10U" ; \*15-15U" ; \*30-30U" ; \*50-50U"  
SN-Bright tin plating 70U"  
SN1-Bright tin plating 120U"Min. ;  
SW-Fog Tin plating
- ⑨ Color:  
Blank-natural color

Poles	Dimension s(mm)		
	A	B	C
02	9.70	3.00	12.50
03	12.70	6.00	15.50
04	15.70	9.00	18.50
05	18.70	12.00	21.50
06	21.70	15.00	24.50
07	24.70	18.00	27.50
08	27.70	21.00	30.50
09	30.70	24.00	33.50
10	33.70	27.00	36.50
11	36.70	30.00	39.50
12	39.70	33.00	42.50

X3025 WVS-XXD-LPSW	LCP UL 94V-0	Brass	Tin Plated Fog	Brass	Tin Plated Fog	X3025H
X3025 WVS-XXD-LPSN	LCP UL 94V-0		Tin-Plated		Tin-Plated	
PART NO	Material	Material(Pin)	Finish(Pin)	Material (Solder Tabs)	Finish (Solder Tabs)	

广东星坤科技股份有限公司 PCB LAYOUT

MARK	DESCRIPTION	DATE	REVISED	APPROVED	UNSPECIFIED TOLERANCES
Δ*	日期				
Δx	日期				
Δx	日期				
文件	工程章				

DSND	DATE	SCALE: N/A	MODEL TYPE:
DWN	DATE <td>VIEW: </td> <td>X3025WVS-XXD-LPXX</td>	VIEW:	X3025WVS-XXD-LPXX
CHKD	DATE <td>UNIT: mm/in</td> <td>PART NO.:</td>	UNIT: mm/in	PART NO.:
APPD	DATE <td>SIZE: A4</td> <td>3.00mm Crimp Style Connectors</td>	SIZE: A4	3.00mm Crimp Style Connectors
XKB INDUSTRIAL PRECISION CO., LIMITED			DWG NO.:
WEIGHT	SHEET	REVISION	
1.0g	1/1	A0	