

REV	CONTENT	CHK	DATE
V0.0	CONTENT	CXL	14.11.06

NOTES:

1. Rating: 300V 10A;
2. Insulation Withstands Voltage: AC1600V / MIN;
3. Insulation Resistance: 500M $\Omega$  or more at DC500V;
4. Using Temperature Range: -40 $^{\circ}$ C / +105 $^{\circ}$ C;
5. Suitable Electric Wire: 22-14 AWG
6. Insulation stripping length: 7 mm.
7. RoHS compliance
8. "★" the important dimension.

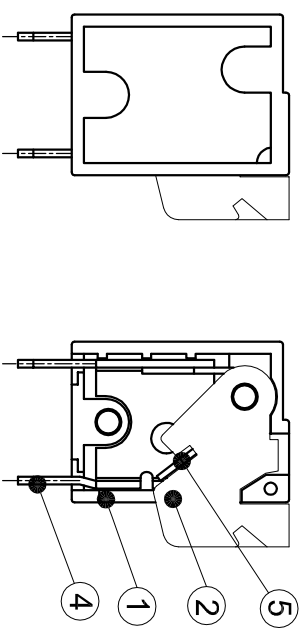
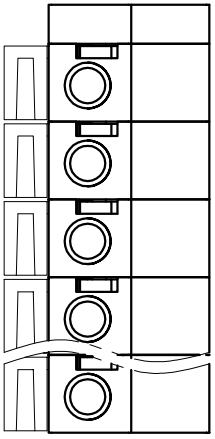
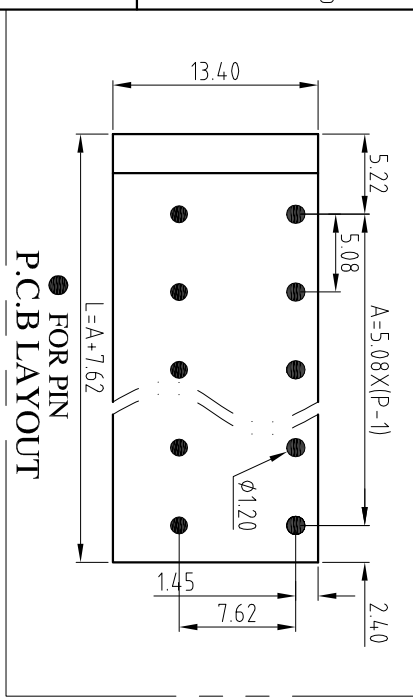

SECTION A-A

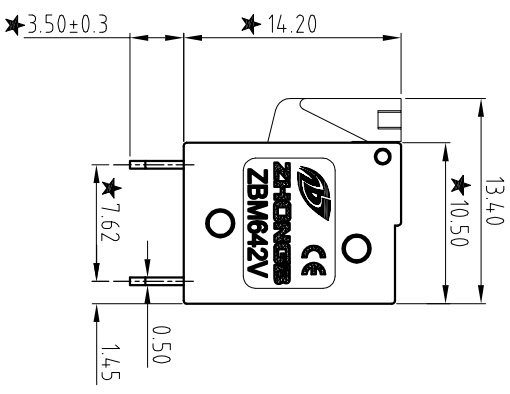
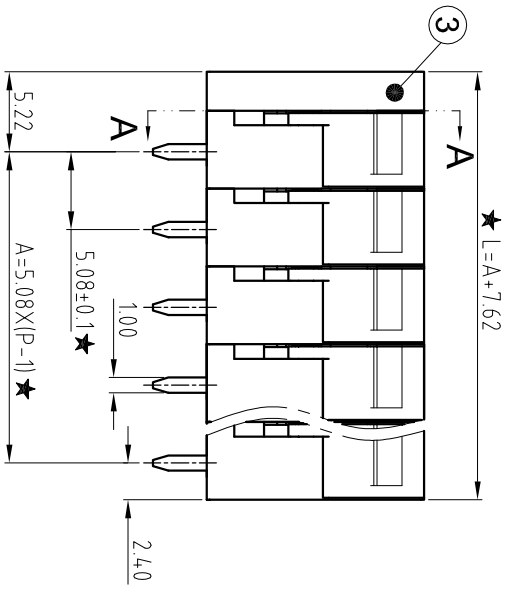

P	2	3	4	5	6	7	8	9	10	11	12	13	14	15	16	17	18	19	20	21	22	23	24
L	12.70	17.78	22.86	27.94	33.02	38.10	43.18	48.26	53.34	58.42	63.50	68.58	73.66	78.74	83.82	88.90	93.98	99.06	104.14	109.22	114.30	119.38	124.46
A	5.08	10.16	15.24	20.32	25.40	30.48	35.56	40.64	45.72	50.80	55.88	60.96	66.04	71.12	76.20	81.28	86.36	91.44	96.52	101.60	106.68	111.76	116.84

Total Pitch Tolerances		Nominal dimension range	
In	mm	In	mm
over	0	over	0
to	30	to	53
to	53	to	70
to	70	to	90
to	90	to	115
to	115	to	150
to	150	to	200
to	200	to	250
to	250	to	300
to	300	to	350
to	350	to	400
to	400	to	450
to	450	to	500
to	500	to	550
to	550	to	600
to	600	to	650
to	650	to	700
to	700	to	750
to	750	to	800
to	800	to	850
to	850	to	900
to	900	to	950
to	950	to	1000
to	1000	to	1050
to	1050	to	1100
to	1100	to	1150
to	1150	to	1200
to	1200	to	1250
to	1250	to	1300
to	1300	to	1350
to	1350	to	1400
to	1400	to	1450
to	1450	to	1500
to	1500	to	1550
to	1550	to	1600
to	1600	to	1650
to	1650	to	1700
to	1700	to	1750
to	1750	to	1800
to	1800	to	1850
to	1850	to	1900
to	1900	to	1950
to	1950	to	2000
to	2000	to	2050
to	2050	to	2100
to	2100	to	2150
to	2150	to	2200
to	2200	to	2250
to	2250	to	2300
to	2300	to	2350
to	2350	to	2400
to	2400	to	2450
to	2450	to	2500
to	2500	to	2550
to	2550	to	2600
to	2600	to	2650
to	2650	to	2700
to	2700	to	2750
to	2750	to	2800
to	2800	to	2850
to	2850	to	2900
to	2900	to	2950
to	2950	to	3000
to	3000	to	3050
to	3050	to	3100
to	3100	to	3150
to	3150	to	3200
to	3200	to	3250
to	3250	to	3300
to	3300	to	3350
to	3350	to	3400
to	3400	to	3450
to	3450	to	3500
to	3500	to	3550
to	3550	to	3600
to	3600	to	3650
to	3650	to	3700
to	3700	to	3750
to	3750	to	3800
to	3800	to	3850
to	3850	to	3900
to	3900	to	3950
to	3950	to	4000
to	4000	to	4050
to	4050	to	4100
to	4100	to	4150
to	4150	to	4200
to	4200	to	4250
to	4250	to	4300
to	4300	to	4350
to	4350	to	4400
to	4400	to	4450
to	4450	to	4500
to	4500	to	4550
to	4550	to	4600
to	4600	to	4650
to	4650	to	4700
to	4700	to	4750
to	4750	to	4800
to	4800	to	4850
to	4850	to	4900
to	4900	to	4950
to	4950	to	5000
to	5000	to	5050
to	5050	to	5100
to	5100	to	5150
to	5150	to	5200
to	5200	to	5250
to	5250	to	5300
to	5300	to	5350
to	5350	to	5400
to	5400	to	5450
to	5450	to	5500
to	5500	to	5550
to	5550	to	5600
to	5600	to	5650
to	5650	to	5700
to	5700	to	5750
to	5750	to	5800
to	5800	to	5850
to	5850	to	5900
to	5900	to	5950
to	5950	to	6000
to	6000	to	6050
to	6050	to	6100
to	6100	to	6150
to	6150	to	6200
to	6200	to	6250
to	6250	to	6300
to	6300	to	6350
to	6350	to	6400
to	6400	to	6450
to	6450	to	6500
to	6500	to	6550
to	6550	to	6600
to	6600	to	6650
to	6650	to	6700
to	6700	to	6750
to	6750	to	6800
to	6800	to	6850
to	6850	to	6900
to	6900	to	6950
to	6950	to	7000
to	7000	to	7050
to	7050	to	7100
to	7100	to	7150
to	7150	to	7200
to	7200	to	7250
to	7250	to	7300
to	7300	to	7350
to	7350	to	7400
to	7400	to	7450
to	7450	to	7500
to	7500	to	7550
to	7550	to	7600
to	7600	to	7650
to	7650	to	7700
to	7700	to	7750
to	7750	to	7800
to	7800	to	7850
to	7850	to	7900
to	7900	to	7950
to	7950	to	8000
to	8000	to	8050
to	8050	to	8100
to	8100	to	8150
to	8150	to	8200
to	8200	to	8250
to	8250	to	8300
to	8300	to	8350
to	8350	to	8400
to	8400	to	8450
to	8450	to	8500
to	8500	to	8550
to	8550	to	8600
to	8600	to	8650
to	8650	to	8700
to	8700	to	8750
to	8750	to	8800
to	8800	to	8850
to	8850	to	8900
to	8900	to	8950
to	8950	to	9000
to	9000	to	9050
to	9050	to	9100
to	9100	to	9150
to	9150	to	9200
to	9200	to	9250
to	9250	to	9300
to	9300	to	9350
to	9350	to	9400
to	9400	to	9450
to	9450	to	9500
to	9500	to	9550
to	9550	to	9600
to	9600	to	9650
to	9650	to	9700
to	9700	to	9750
to	9750	to	9800
to	9800	to	9850
to	9850	to	9900
to	9900	to	9950
to	9950	to	10000

ITEM	NAME OF PART	NO. OF PART	Q'TY	MATERIAL	NOTE
1	HOUSING	ZM642A0XXX	P	PA66(UL94V-0)	GREEN
2	LEVER	ZM642A1XXX	P	POM-V2	ORANGE
3	END COVER	ZM642A2XXX	1	PA66(UL94V-0)	GREEN
4	SOLDER PIN	ZM642B0001	P	BRASS	Sn Plated
5	SPRING COIL	ZM642B0003	P	STAINLESS	

DWG	CXL	DATE	SCALE
		14.10.30	1:1

CHK	DATE	NAME
		ZBM642V-XP-X

APP	DATE	NAME
		ZBM642V-XP-X

DWGNO	SCALE	SHEET/OF
ZB-02-ZBM642VXPX	1:1	1/1