

REV	CONTENT	CHK	DATE
V0.0	CONTENT	SK	2014-11-29

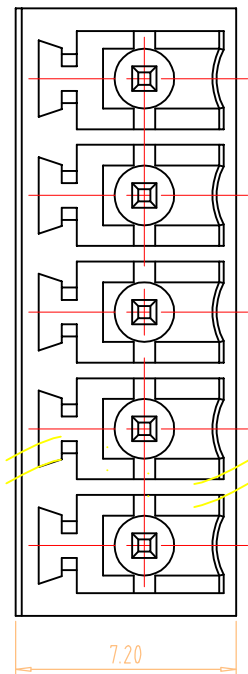
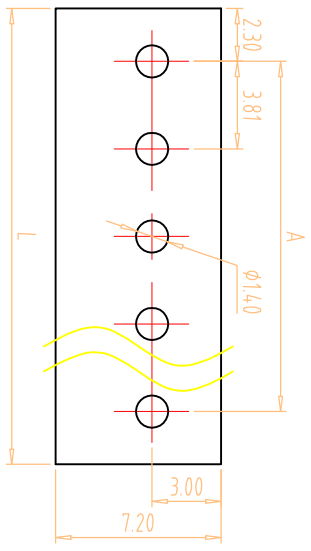
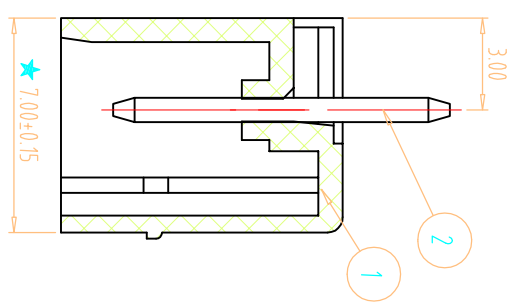
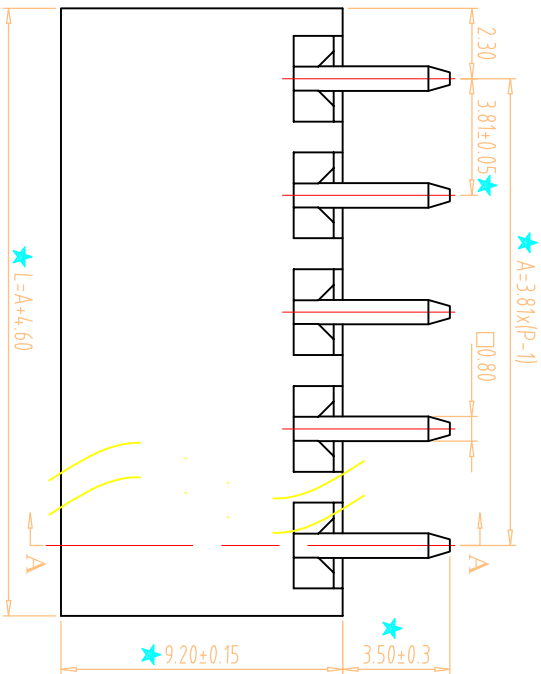
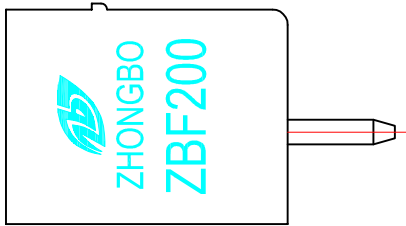

NOTES:
 1.Rating:300V 8A ,
 2.Insulation Withstands Voltage: AC2000V/MIN
 3.Insulation Resistance: 500MΩ or more at DC500V
 4.Using Temperature Range: -40°C---+105°C
 5.“★” is the important dimension

PCB LAYOUT
S=3:1

Total Pitch Tolerances						Nominal dimension range										⊥		≡			//								
in mm						in mm																							
over	over	over	over	over	over	0	30	53	70	90	115	150	250	350	0	30	53	70	90	115	150	200	250	0	100	0	100	0	150
to	to	to	to	to	to	to	to	to	to	to	to	to	to	to	to	to	to	to	to	to	to	to	to	to	to	to	to	to	
±0.18	±0.20	±0.25	±0.3	±0.35	±0.44	±0.50	±0.70	±0.85	±0.20	±0.25	±0.30	±0.35	±0.44	±0.55	±0.70	±0.80	±0.90	0.2	0.3	0.3	0.2	0.3	0.5	0.3	0.5	0.2	0.3	0.5	

2	PIN	ZF100B0001	P	BRASS	Sn Plated
1	HOUSING	ZF200A0XXXX	1	PA66(V0)	
	NAME OF PART	NO. OF PART	Q'TY	MATERIAL	NOTE
DWG	cxl	DATE	DATE	SCALE	15----3.81(1:1.0)
		14.06.06		A4	UNITS mm
CHK	DATE			SHEET/OF	1 / 1
APP	DATE			NAME	ZBF200V-XXP-X
NINGBO ZHONGBO PHOTOVOLTAIC TECHNOLOGY CO., LTD				DWGNO.	ZB-02-ZBF200VXXPX

