

REV	CONTENT	CHK	DATE
V0.0	CONTENT	CXL	14.06.06

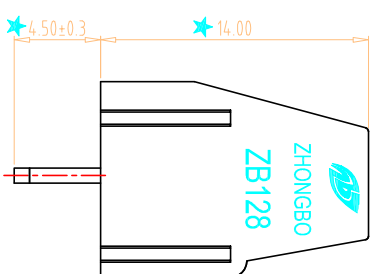

- NOTES:
1. Rating:300V 10A.
  2. Insulation Withstands Voltage: AC2000V/MIN
  3. Insulation Resistance:  
≥500MΩ or more at DC500V
  4. Using Temperature Range: -40°C/+105°C
  5. Screw Torque Value:0.4Nm
  6. Suitable Electric Wire: 12-22AWG

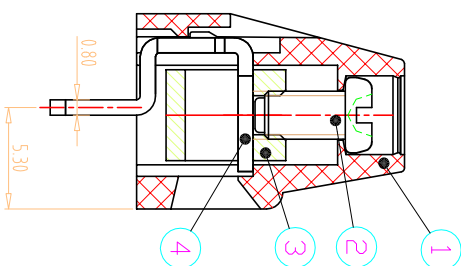
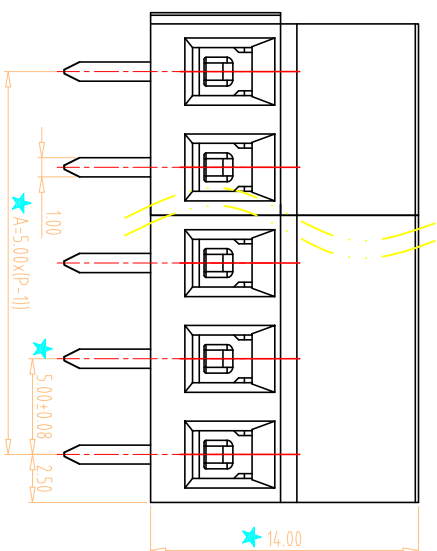
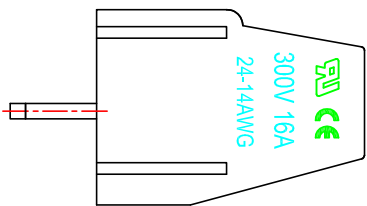
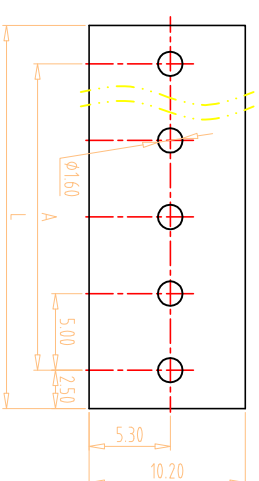
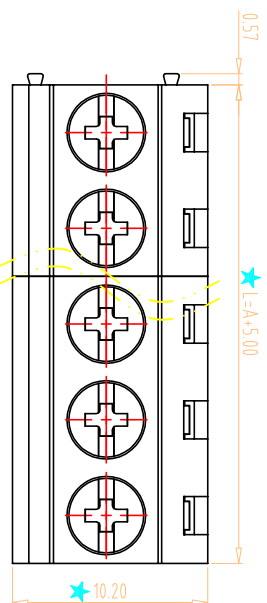

**PCB LAYOUT**  
S=2:1

Total Pitch Tolerances		Nominal dimension range	
	In mm		In mm
over	over	over	over
0	30	53	90
to	to	to	to
30	53	70	90
to	to	to	to
53	70	90	115
to	to	to	to
70	90	115	150
to	to	to	to
90	115	150	200
to	to	to	to
115	150	200	250
to	to	to	to
150	200	250	320
to	to	to	to
200	250	320	30
to	to	to	to
250	320	30	53
to	to	to	to
320	30	53	70
to	to	to	to
30	53	70	90
to	to	to	to
53	70	90	115
to	to	to	to
70	90	115	150
to	to	to	to
90	115	150	200
to	to	to	to
115	150	200	250
to	to	to	to
150	200	250	320
to	to	to	to
200	250	320	10
to	to	to	to
250	320	10	0.2
to	to	to	to
320	10	0.2	0.3
to	to	to	to
10	0.2	0.3	0.3
to	to	to	to
0.2	0.3	0.3	0.2
to	to	to	to
0.3	0.3	0.2	0.3
to	to	to	to
0.3	0.3	0.3	0.5
to	to	to	to
0.5	0.5	0.5	0.5

ITEM	NAME OF PART	NO. OF PART	Q'TY	MATERIAL	NOTE
4	SOLDER PIN	ZB128B0001	P	BRASS	Tin Plated
3	BLOCK	ZBXC0001	P	BRASS	Ni Plated
2	SCREW	ZBST0022	P	STEEL	M2.5/Zn Plated
1	HOUSING	ZB128A0XX02 ZB128A0XX03	/	PA66(V0)	

DWG	HUITAO	DATE	13.09.26	UNITS	mm	SHEET/OF	1 / 1
CHK	DATE	SCALE	2.5:1	A4			
APP	DATE	NAME					

NINGBO ZHONGBO PHOTOVOLTAIC TECHNOLOGY CO., LTD  
**ZB128V-XXP-XC(128-模组)**  
 DWGNO: ZB-02-ZB128VXXPXC